

CONCRETE MASONRY FENCE WALL

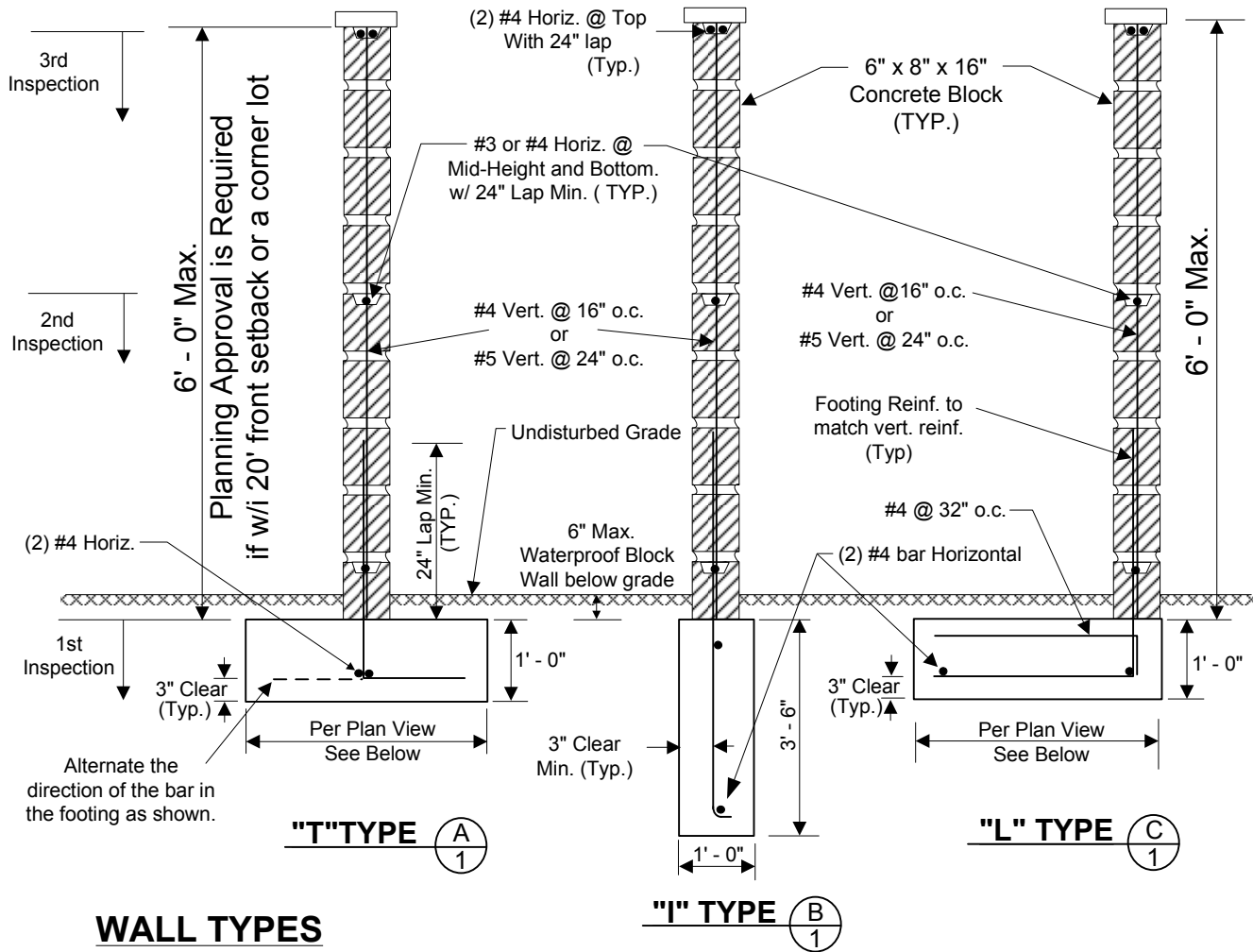

NOTE: NOT APPLICABLE AT AREAS OF HILLS, RIDGES, AND ESCARPMENTS AS SHOWN IN DETAIL (D/2). (ASCE 6.5.7.1)

PLAN VIEW

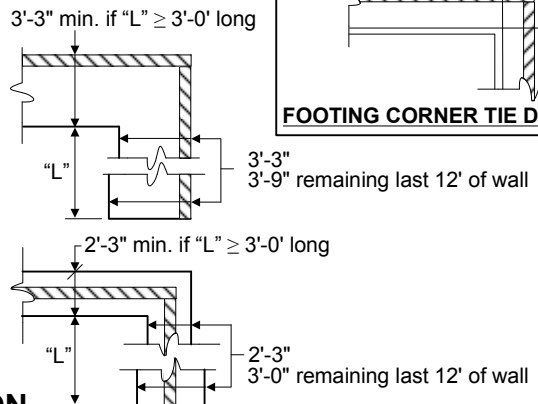
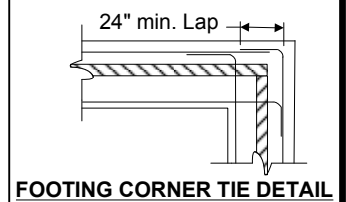
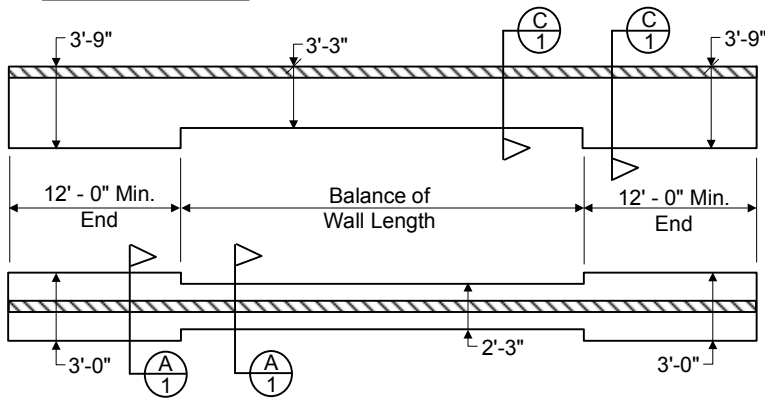

CITY OF SANTA CLARITA

BUILDING & SAFETY DIVISION

23920 Valencia Boulevard, Suite 140
Santa Clarita, CA 91355 (661) 255-4935

CONCRETE MASONRY FENCE WALL

GENERAL SPECIFICATIONS & NOTES

- 1) Concrete mix for footings to be 1 part cement to 2-1/2 parts sand to 3-1/2 parts gravel with a maximum of 7-1/2 gallons of water per sack of cement. $f_c = 2500$ psi
- 2) Concrete block units shall conform to ASTM C90 & ASTM C140, 1900 psi.
- 3) Reinforcing steel to be deformed and conform to ASTM A615 Grade 40
- 4) Concrete block units are to be staggered.
- 5) Concrete block units to have vertical continuity of the cells unobstructed. All cells containing reinforcing shall be solid grouted (vertical and horizontal reinforcement).
- 6) Mortar (ATSM C270) Type "S" mix for concrete blocks to be 1 part cement to 1/2 parts lime to 3 parts damp sand.
- 7) Grout (ASTM C476, 2,000 psi) mix for concrete block wall to be 1 part cement to 3 parts sand to which may be more than 1/10 part lime. Sufficient water to be added to produce consistency for pouring segregation of the constituents. The grout may contain 2 parts pea gravel, maximum size.
- 8) Slump stone shall have full width interior cell dimension.
- 9) Block fence may be placed to either edge of "I" type of foundation.
- 10) First inspection to be after trenches are ready for concrete and all required steel is tied in place.

Second inspection at mid-height bond beam and before lower half grout. Third inspection at top bond beam and before upper half grout.

Final inspection to verify the work is completed prior to installing top cap.
- 11) Foundation must be poured against undisturbed soil with no appreciable slope of side walls.
- 12) **Construction of block walls over 42" in height require a building permit from Building & Safety, prior to commencing construction.**



CITY OF SANTA CLARITA

BUILDING & SAFETY DIVISION

23920 Valencia Boulevard, Suite 140
Santa Clarita, CA 91355 (661) 255-4935